

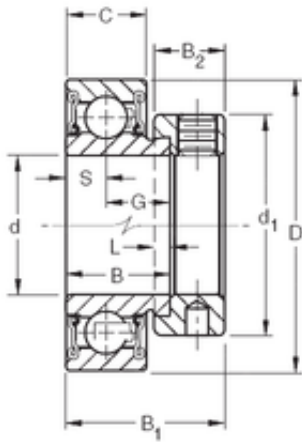

NTN BEARING DRIVESHAFT,INC.



19.05 mm x 47 mm x 21,44 mm TIMKEN RA012RR Insert Bearings Cylindrical OD

Bearing No. RA012RR

Size	19.05x47x21.44 mm
Bore Diameter	19.05 mm
Outer Diameter	47 mm
Width	21,44 mm
d	19.05 mm
D	47 mm
B	21,44 mm
C	15 mm
d1	33,3 mm
B1	31 mm
B2	13,5 mm
G	13,92 mm
L	4 mm
S	7,49 mm
Weight	0,132 Kg
Basic dynamic load rating (C)	14,3 kN

RA012RR Bearing 2D drawings and 3D CAD models